

Flow Rate and Chlorine Reduction

The aquasana shower filter system is designed to provide the highest quality of water with the least amount of pressure loss. The unit uses an exclusive two stage filtering process to substantially reduce chlorine and enhance pH balance. While some pressure will be lost in the filtering process, the result will be substantial water savings. In compliance with California law, the filter is regulated to a maximum flow rate of 2.5 gallons per minute.

In some areas where water pressure and flow rates are higher or in areas where the chlorine levels exceed 1 ppm (part per million), the chlorine reduction level may be reduced. You can increase the filtering performance by slowing down your water flow rate with a flow restricter, (available at most plumbing supplies for \$1 to \$2) or by adjusting the water flow manually.

The aquasana filter cartridge is designed to last 6 months under normal conditions. If you use the filter more than twice each day, take showers longer than 10 minutes or your city uses surface (lake or river) water, it is recommended that the filter be changed every 3-4 months. Surface water typically has higher levels of sediment and chlorine and will exhaust the filter media more rapidly.

Fig. A

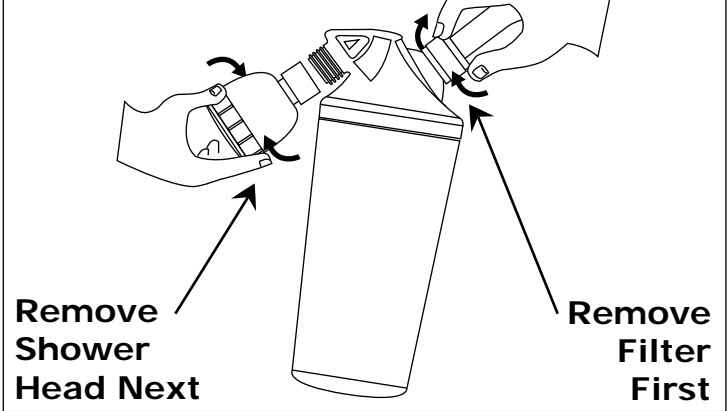

Fig. B

